

Field Installation Procedure



WOOD STONE GAS PLANCHA

Specialty Equipment

Zip Tube Replacement

WOOD STONE GAS PLANCHA

WS-PL-4836-4-CT



WOOD STONE CORPORATION

1801 W. Bakerview Rd.
Bellingham, WA 98226 USA

Toll Free 800.988.8103

Tel 360.650.1111

Fax 360.650.1166



TOOLS REQUIRED:

Wrenches

- #3 Phillips Screwdriver
- 7/16" Socket Driver
- 5/16" • 1/2" • 5/8"
- 7/16" • 9/16"

DISCONNECT POWER AND GAS BEFORE PROCEEDING

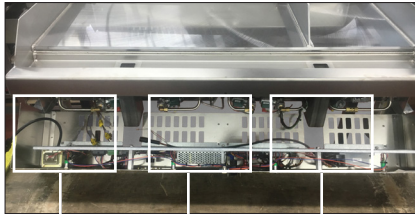

1. Open Front Panel and disconnect:

- Power cord
- Igniter wire & Ground clip
- Thermocouples
- Wire Harness connector

2. Remove Front Panel and put away in a safe place.

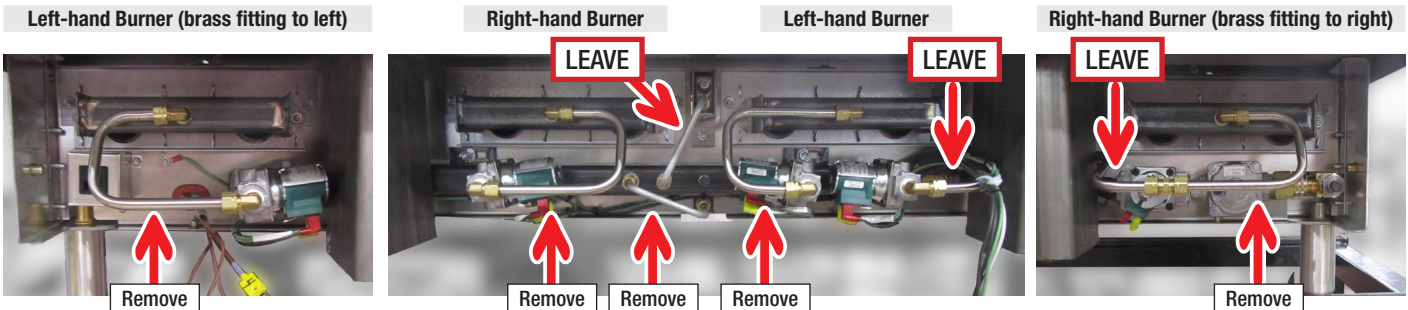
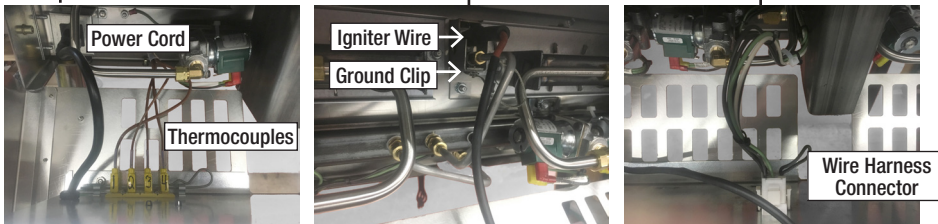

3. Remove the 4 Gas Lines between the Gas Valves and Burner Manifold (**wrenches: 5/8" & 9/16"**)

4. Remove the Gas Line between the Gas Manifold and Zip Tube Manifold (**wrench: 1/2"**).

Note: Do not remove the Dogleg Gas Line and the line between the Gas Manifold & Igniter.

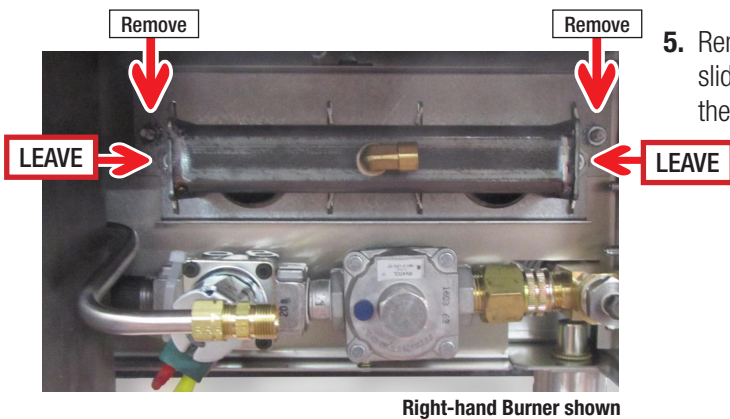

Right-hand Burner shown

5. Remove the 2 "outside" bolts each from the 4 Burner Cassettes and slide each out (**7/16" socket driver**). **Note:** Leave the bolts fastening the Dual Manifold to the Cassettes.

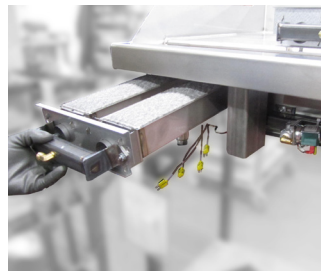

Tip: Note that Burner Cassettes are either left- or right-handed, determined by the direction of the brass fitting. You'll need to reinstall in proper position. Orientation: **LH - RH - LH - RH.**

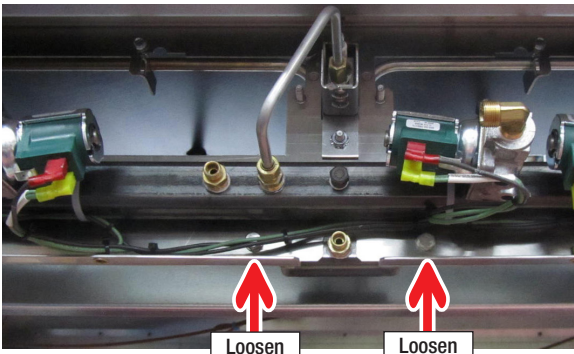

6. Loosen the 2 Zip Tube Manifold screws (7/16" socket driver) – **Do Not Remove.**

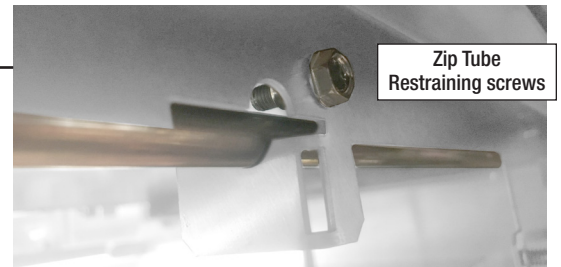
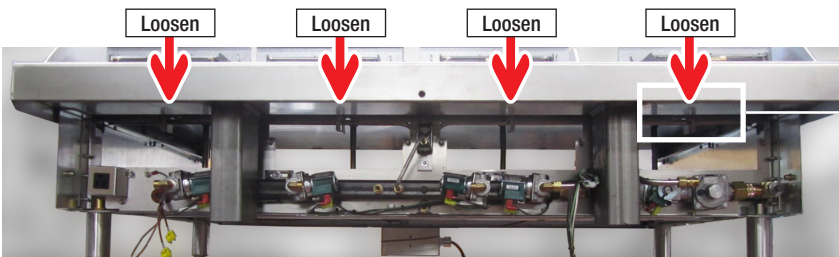

7. Loosen the 4 Zip Tube Restraining Screws– **Do Not Remove.**

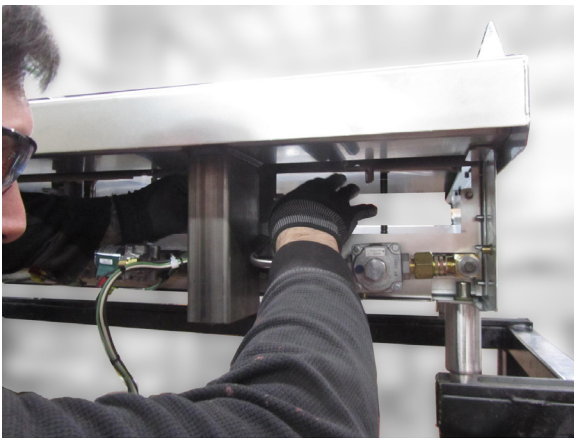

8. Lift each Zip Tube up and out from unit.
9. Place new Zip Tubes into position.
Note: The holes in Zip Tubes will face towards back, and the ends of the shorter leg will fit over the Jets of the Zip Tube Manifold. *Placement will need to be done by feel.*

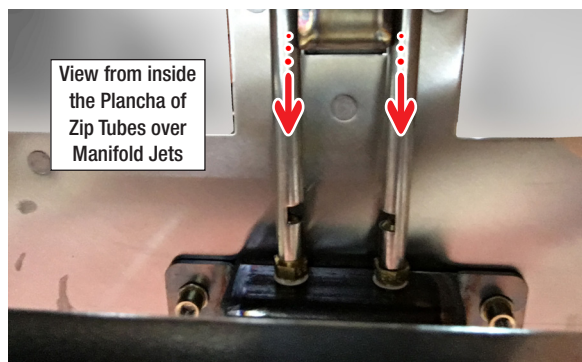

10. Re-tighten 4 Zip Tube Restraining bolts to secure Zip Tube.

Note: Make certain that Zip Tube is laying flat, and screws are on over the Zip Tube and not pushing it out of place.



11. Re-tighten 2 Zip Tube Manifold bolts (**7/16" socket driver**) (see Step 6).

Note: After tightening, verify that the Zip Tubes are still properly seated.

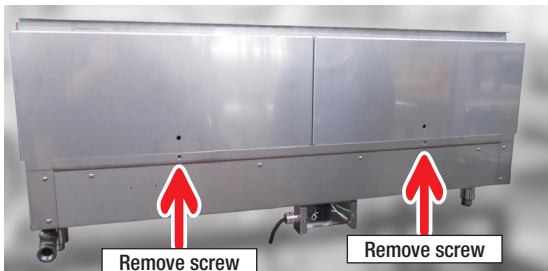

12. Re-install 4 Burner Cassettes by first removing Rear Flue Covers (**#3 Phillips**).

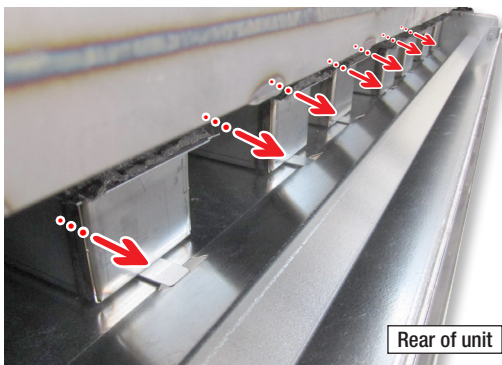

13. Insert Burner Cassette into opening from front, and from rear, verify the tabs on the back of the Cassette are seated into notch of the cabinet.

Note: Make certain Burners are installed in proper positions. Orientation: **LH - RH - LH - RH**. Direction of Brass Fitting determines Left- and Right-Hand Burners (see photo Step 3 & 4).

14. Reinstall 2 bolts to secure each Burner Cassette (**7/16" socket driver**) (see Step 5).

15. Reinstall Gas Lines (see Steps 3 and 4).

16. Reconnect connectors between Front Panel and unit, keeping Front Panel detached at this point (see Step 1).

17. Reconnect Power and Gas.

18. Turn the unit ON. When the Main Solenoid Valve energizes:

- View the Pilot from the rear and
- Verify that both Zip Tubes light within 6–8 seconds after the Solenoid Valve energizes, or within 4 seconds after the Pilot Flame appears.

Both Tubes MUST light the first time when the unit is cold.

19. Leak Check

20. Reinstall Rear Flue Covers.

20. Reinstall Front Panel.

QUESTIONS?

Give us a call at **800.988.8103**

Our normal service hours are 8am to 5pm Pacific time Mon–Fri. If calling after hours, follow the recorded instructions for emergency service and a Wood Stone technician will get back to you promptly.